

# PLAT OF SURVEY

LOTS 1 THRU 5 OF BLOCK 15  
FOUR LAKES BEACH

A SUBDIVISION LOCATED IN SECTION 8  
TOWN 4 NORTH, RANGE 17 EAST  
WALWORTH COUNTY, WISCONSIN

NOTE: COPIES OF THIS MAP TO WHICH THE FOLLOWING  
CERTIFICATE WILL APPLY ARE BLUE LINE PRINTS SHOWING  
SURVEYOR'S ORIGINAL SEAL AND SIGNATURE IN BLACK INK.  
COPIES BY ANY OTHER MEANS MAY HAVE ALTERATIONS WHICH  
DO NOT REPRESENT THE SURVEYOR'S WORK PRODUCT.

I HEREBY CERTIFY THAT THE ABOVE DESCRIBED PROPERTY  
HAS BEEN SURVEYED UNDER MY DIRECTION AND THAT THE  
ABOVE MAP IS A TRUE REPRESENTATION THEREOF AND SHOWS  
THE SIZE AND LOCATION OF THE PROPERTY AND ITS  
EXTERIOR BOUNDARIES. THIS SURVEY IS MADE FOR THE  
USE OF THE PRESENT OWNERS OF THE PROPERTY, AND ALSO  
THOSE WHO PURCHASE, MORTGAGE, OR GUARANTEE THE TITLE  
THERETO WITHIN ONE YEAR FROM THE DATE HEREOF.

DATED: 8-5-1996

*Peter S. Gordon*  
PETER S. GORDON R.L.S. 2101

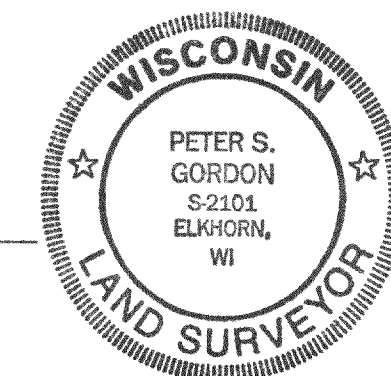

○ = FOUND IRON PIPE STAKE  
(x) = RECORDED AS

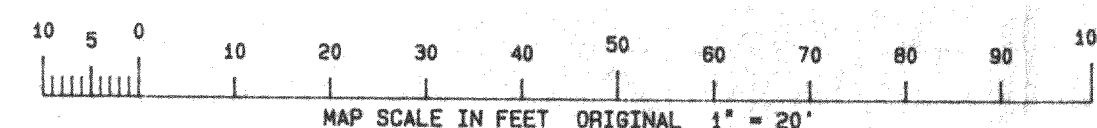

FOUR LAKES BEACH PARK

PETERS LAKE

WORK ORDERED BY: CZAR CONSTRUCTION  
W 5213 STERLINGWORTH COURT  
ELKHORN, WISCONSIN 53121

FARRIS, HANSEN & ASSOCIATES, INC.  
Engineering, Architecture, Surveying  
7 Ridgway Court P.O. Box 437  
ELKHORN, WISCONSIN 53121  
Office: (414) 723-2096  
Fax: (414) 723-5886

4586  
08/05/96  
1 OF 1

LFL-38  
LFL-38A  
LFL-39  
417-453